

TITAN 300W RECEIVER FLOODLIGHT

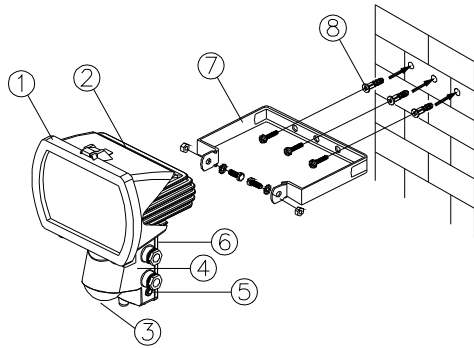

- ① Front Surround
- ② Floodlight
- ③ RX Module
- ④ Wiring Box
- ⑤ Learning Key
- ⑥ Wiring Box Cover
- ⑦ Mounting Bracket
- ⑧ Screw & Plastic Wall Plug

INTRODUCTION

The TITAN 300W RECEIVER FLOODLIGHT is part of a unique lighting system for home or business use. During darkness, the built-in receiver activates the FLOODLIGHT when a signal is received from a transmitter in the TRS range. During daylight, the built-in photocell sensor saves energy by deactivating the FLOODLIGHT.

This FLOODLIGHT RECEIVER is compatible with the entire range of TRS transmitters.

Note: Please read this entire manual before you start to install the system.

SAFETY PRECAUTIONS

- DO NOT install when it is raining.
- Isolate the power supply before installation.
- UK Building Regulations require mains installations be carried out by a qualified electrician.
- BS7671:2001 IEE Wiring Regulations must be complied with in all respects.
- HO5RNF round flexible cable and drip loops must be used to avoid water ingress damage to the unit.
- Ensure that the power supply is protected by a 16A circuit breaker or suitable fuse.
- Ensure minimum distance of 0.5m away from lighted objects.
- The unit must be installed vertically (FIGURE 1), NOT horizontally (FIGURE 2).
- DO NOT tilt the floodlight forward more than 45 degrees from the vertical (FIGURE 3).

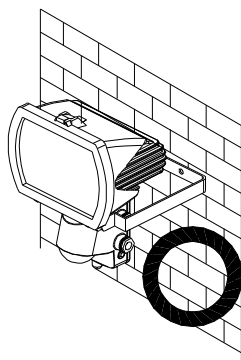

VERTICAL
FIGURE 1

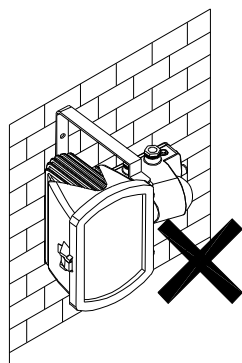

HORIZONTAL
FIGURE 2

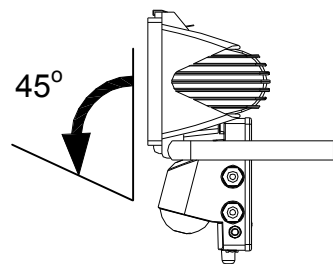

FIGURE 3

CHOOSING A MOUNTING LOCATION

- For the best results, mount the Floodlight onto normal brickwork, 1.8~2.4m above the ground.
- Installation under eaves is acceptable but radiated and convected heat from the fitting must be taken into account.
- Avoid large metal structures these may block or distort signals from the TRS transmitters.

INSTALLATION WIRING INSTRUCTION

- **WARNING** isolate the power supply before installation.

It is advisable to install a single pole wall switch (FIGURE 4). This will allow easy control of the floodlight.

- 1) Undo the four fixing screws from the wiring box cover and remove the cover (FIGURE 5).
- 2) Unscrew one of the cable glands and using a suitable tool pierce a hole on the cable grommet. Route the HO5RNF supply cable through the cable gland and grommet (FIGURE 6).
- 3) Strip approximately 6mm of insulation from each of the 3 cores of the supply cable, refer to FIGURE 7.

Connect the BROWN wire (Live wire) to the terminal marked "L".

Connect the BLUE wire (Neutral wire) to the terminal marked "N".

Connect the YELLOW/GREEN (Earth wire) to the terminal block marked '⏚'.

An additional lighting load (maximum 1000W incandescent) may be connected to the floodlight using HO5RNF cable: Connect the BROWN wire (Live wire) of the additional lighting load to the terminal marked "LS". Connect the BLUE wire (Neutral wire) of the additional lighting load to the terminal marked "N1". Use the second cable gland for the additional lighting load supply cable.

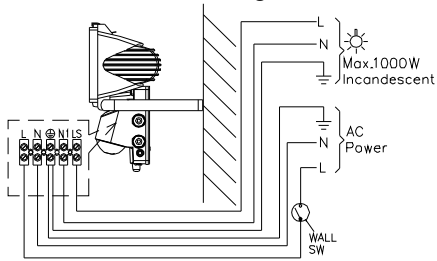

FIGURE 4

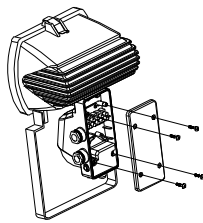

FIGURE 5

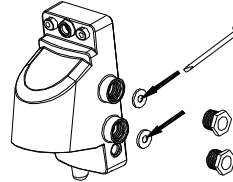

FIGURE 6

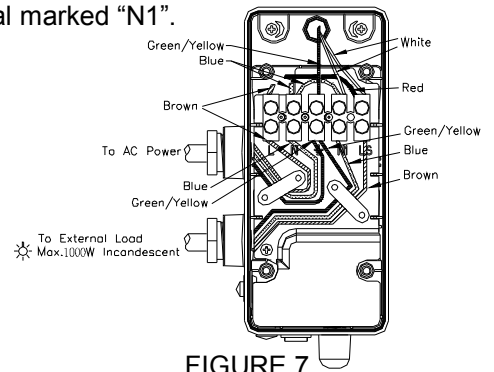

FIGURE 7

- 4) Remove the mounting bracket from the floodlight. Drill the wall and screw the bracket onto the wall using suitable wall plugs and screws (FIGURE 8).

5) Re-attach the floodlight to the bracket and secure the supply cable (and additional lighting load supply cable if applicable) to the wall using suitable clips. Ensure that the cable is not touching the body of the floodlight, and that there is sufficient slack in the cable to allow the floodlight to be tilted and adjusted as required (FIGURE 9). NB: Tilt and adjust the floodlight by grasping the metal body of the floodlight, not the wiring box.

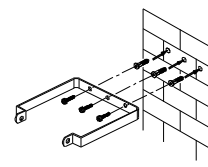

FIGURE 8

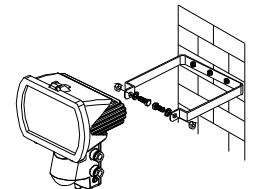

FIGURE 9

LAMP INSTALLATION

CAUTION: DO always handle halogen lamps with a soft clean cloth.
DO NOT touch the lamp with bare hands as this will dramatically shorten the life of the lamp.
DO NOT touch the floodlight while it is in use or still hot. Allow it to cool before touching it.
DO NOT use a halogen lamp rated higher than 300 watts.

- **WARNING** isolate the power supply before installation.

- 1) Use a flat blade screwdriver to open the front cover clip on the floodlight (FIGURE 10).
- 2) Pull down the front surround which is mounted on hinges and will swing open (FIGURE 11).
- 3) Install the lamp by inserting one end into the lamp holder and depressing until enough clearance is gained to seat the other end of the lamp into the lamp holder. Rotate the halogen lamp to ensure proper seating (FIGURE 12).
- 4) Refit the front surround and secure with the front cover clip (FIGURE 13).

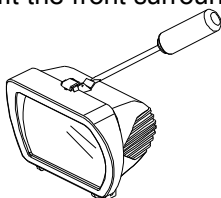

FIGURE 10

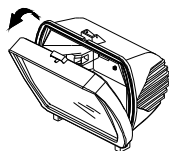

FIGURE 11

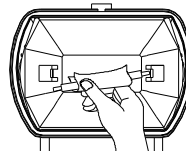

FIGURE 12

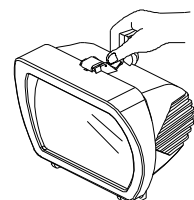

FIGURE 13

FIRST TIME POWER UP

- Turn the LUX control on the bottom of the floodlight wiring box fully anticlockwise to the T position (FIGURE 14).



FIGURE 14

- Reinststate the power supply to the floodlight and switch the floodlight on from the wall switch if installed. The led indicator on the bottom of the floodlight wiring box (FIGURE 15) will flash on and off continuously to indicate that no codes are installed in the floodlights memory. The floodlight can memorise the codes for up to twelve separate TRS transmitters.

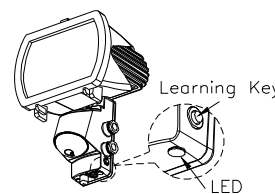

FIGURE 15

To enable the receiver to memorise TRS transmitter codes proceed as follows:

1) Activate the floodlight receiver learning mode by pushing and holding in the Learning Key button, located on the side of the receiver floodlight wiring box, for more than three seconds (FIGURE 15). The led on the receiver floodlight will illuminate whilst you hold in the Learning Key button and then extinguish, release the Learning Key button. The led will flash briefly to indicate the receiver is in learning mode. The receiver will remain in learning mode for approximately thirty seconds or until a code is received and learnt.

2) Once the receiver is in learning mode activate the learning mode for the TRS transmitter you wish the receiver to learn from. Refer to the instructions for each type of transmitter in order to do this. During learning mode the TRS transmitter should be no less than 30cm and no more than the maximum range of 70m from the receiver.

3) The led on the receiver will stop flashing, illuminate for approximately three seconds and then go off. This indicates that the floodlight receiver has learnt the code.

4) Confirm that the floodlight receiver has correctly learnt the code by activating the relevant transmitter to trigger the floodlight on. Where you wish to test multiple triggers from TRS transmitters the Manual Off function on the floodlight receiver may be useful. Once the floodlight receiver has been triggered on to operate the Manual Off function simply press and release the Learning Key button on the receiver floodlight. This will switch off the receiver floodlight and make it ready to receive the next trigger signal.

NB: a) If the floodlight receiver is triggered on by a TRS transmitter that only has an on function for example the TITAN Magnetic Contact Transmitter or the TITAN Bell Push Transmitter the floodlight receiver will switch on, time out and switch off after approximately 15 minutes. Unless all commands are overridden by the floodlight receiver Lux control.

b) If the floodlight receiver is triggered on by a TRS transmitter that has an on / off function for example the TITAN Remote Control Transmitter or the TITAN Transmitter Switch the floodlight receiver will remain on until a signal is received from the activating transmitter to turn off or until the Manual Off function is activated on the floodlight receiver. The Lux control setting does not override the on command from transmitters with the on / off function.

c) If the floodlight receiver is triggered on by a TRS transmitter that has an on / timer / off function for example the TITAN PIR Transmitter Floodlight or the TITAN PIR Transmitter the floodlight receiver will remain on until an off signal is received from the activating transmitter to turn off. If no off signal is received the floodlight receiver will time out and switch off after approximately 15 minutes or can be turned off by the Manual Off function on the floodlight receiver. Unless all commands are overridden by the floodlight receiver Lux control.

- If the floodlight receiver has failed to learn the code repeat steps 1), 2), 3) and 4) above.

Repeat steps 1), 2), 3) and 4) above for each transmitter you wish the receiver to learn from. Up to the maximum of twelve separate transmitters.

- If you make an error during the code learning sequence, or you wish to clear the memory of the receiver floodlight for another reason proceed as follows:

5) Activate the floodlight receiver learning mode by pushing and holding in the Learning Key button, located on the side of the receiver floodlight wiring box, for more than three seconds (FIGURE 15). The led on the receiver floodlight will illuminate whilst you hold in the Learning Key button and then extinguish, release the Learning Key button. The led will flash briefly to indicate the receiver is in learning mode.

6) Immediately push and hold in the Learning Key button again for more than five seconds. The led on the receiver floodlight will illuminate whilst you hold in the Learning Key button and then extinguish, release the Learning Key button. The led on the receiver floodlight will flash on and off continuously to indicate that the memory has been cleared and no codes are installed in the floodlights memory.

7) Once the receiver floodlight is functioning as required go to the LUX ADJUSTMENT section to complete the installation.

LUX ADJUSTMENT

The LUX adjustment located on the bottom of the receiver floodlight wiring box determines at what light level the receiver floodlight will start operating.

Provisionally turn the LUX control fully clockwise to the moon symbol (dusk) position (FIGURE 14). At this provisional setting the floodlight remains inactive during daylight. At dusk the floodlight will become active. If this provisional setting proves to be unsuitable the LUX control should be adjusted. Simply set the LUX control to the position you desire the floodlight to become active as daylight declines.

TROUBLE SHOOTING

- Floodlight does not turn on:
- Check if the wall switch is turned on.
 - Confirm that you have made the correct wiring connections.
 - Make sure that the lamp has not burned out.
 - Ensure transmitter is working and within range.
 - Carry out code learning sequence again.

SPECIFICATIONS

Power Requirement	AC 230/240v 50Hz
TH Lamp Load	Max. 300W TH Halogen Lamp
Additional Lighting Load	1000W Incandescent
Receiver Frequency	433MHz
Mounting Height	Recommended 1.8 - 2.4m (5.9 - 7.8ft) Solid Wall Mount
Wall Switch Control	On /Off
Learning Key	Code learning, clearance of memory, manual off
Lux Adjustment	5 - 200 lux
Warm Up Time	Approximately 1 minute
Index of Protection	IP44
<i>Specifications subject to change without notice.</i>	

Environmental Concerns:

Please DO NOT dispose of electrical appliances as unsorted waste, use the recycling facilities provided by your local authorities.

Please DO NOT dispose of packaging as unsorted waste, use the recycling facilities provided by your local authorities.

